

169 - PANDA

SERVICE NEWS > 21 GEARBOX > 21.03.06 GEAR ENGAGEMENT/SELECTION CABLES  
SEIZING, HARDENING - SERVICE SOLUTION[Go back to User's Manual](#)

## Service News

Copyright By FCA Italy S.p.A. - Printed 04/08/2006



1.1	✓
Fino a 06/06	✓
<b>ADVANCED SEARCH</b>	
<input type="text"/>	
<b>TYPE</b>	
All	✓
<b>CONTENTS</b>	
Only Titles	✓
<input type="button" value="Advanced Search"/>	

Fiat Panda (169)

all versions

2125 1 261 L F      **GEAR ENGAGEMENT/SELECTION CABLES**  
Seizing, hardening - Service Solution21  
03.06

Manual

- [Technical Specifications](#)
- [Descriptions](#)
- [Diagnosis-and-Testing](#)
- [Inspection](#)
- [Removal-and-Installation](#)
- [Electrical equipment](#)
- [Service News](#)
- [Campaigns](#)
- [Rapid Check](#)
- [Te.Se.O. Newsletters](#)
- [TeSeO technical database](#)



### FAULT COMPLAINED OF

Difficult or impossible to engage all the gears

### TECHNICAL CAUSE

Seizing of the gear engagement cable due to the deterioration of the (PTF) tube inside the outer casing that guides the steel cable.

### OPERATIONS IN PRODUCTION

Fitting of engage engagement/selection cables that conform guaranteed.

### IMPLEMENTATION OF MODIFICATION

Version	Factory	Line	Chassis No.	Organization No.
all versions in question	Tichy	-	554771	267630

### OPERATIONS IN NETWORK

#### NETWORK BEHAVIOUR STANDARDS TOWARDS THE CUSTOMER

- If this problem is reported and confirmed, reassure the Customer that it can be solved by replacing the gear engagement/selection cables.
- After the operation show the Customer what has been done and carry out a test to make sure they are satisfied.

### SERVICE SOLUTION

Only for vehicles in the batch of **chassis from 175913 to 554770**, check that the problem reported is due to the gear engagement/selection cables and, if necessary, replace them following the Operating Cycle below.

#### OPERATION CYCLE

Before replacing the gear engagement/selection cables, check that the hardening of the gear control cable **in all gears** is confirmed proceeding as described below:  
**A)** release the cables on the gearbox side (see Service Manual Op 2125C30) and check that the fault is still present using the gear lever in the passenger compartment.

If after having carried out point A) the fault is no longer present, then the cause of the problem should be sought in the gearbox unit and internal controls.

**B)** release the cables on the passenger compartment side (see Service Manual Op 2125C30) and check that the lever in the passenger compartment moves freely for both engagement and selection.

If the fault is still present after having carried out point B), carry out a thorough fault diagnosis for the passenger compartment inner control mounting replacing it if a problem is found.

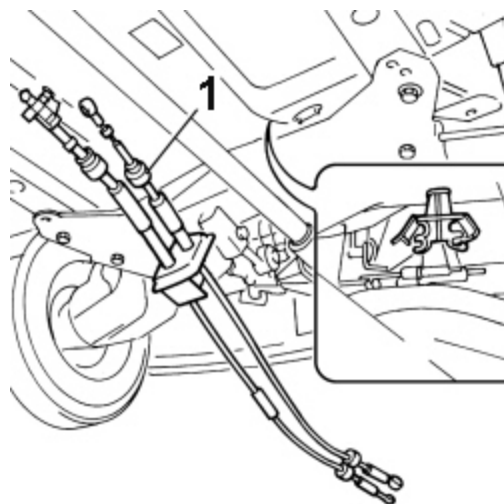
**C)** Replace the gear engagement/selection cables (1 - Fig. 1) with new ones from the Parts Dept. completing the operations already partly carried out in points A and B (refer to the Service Manual - Op 2125C30).**Fig. 1**

### AVAILABILITY OF PARTS