

PANDA 1.2 8v toothed timing belt - r r with engine removed 1032B16

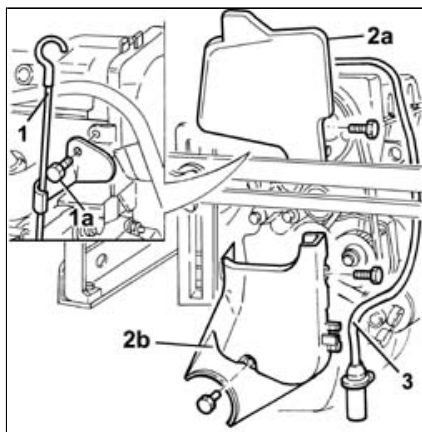

Removing ([Refitting](#))

- **1004D40 engine - position on stand and remove**

1. Undo the bolt (1a) and remove the engine oil dipstick.
2. Remove the upper shield (2a) and the lower shield (2b) for the timing drive belt.
3. Disconnect the electrical connection, release the electrical cable for the rpm and T.D.C. sensor from the fastenings on the protective timing belt covers and remove the rpm sensor.

C	Name	Connector
-	Rpm sensor	K46

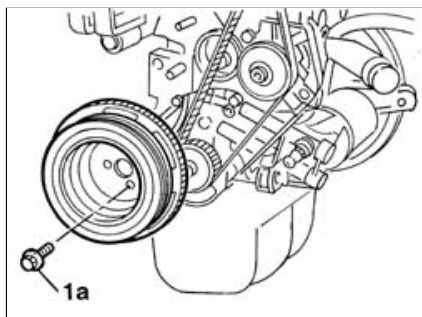

1. Undo the bolts (1a) and remove the auxiliary shaft pulley on the crankshaft.

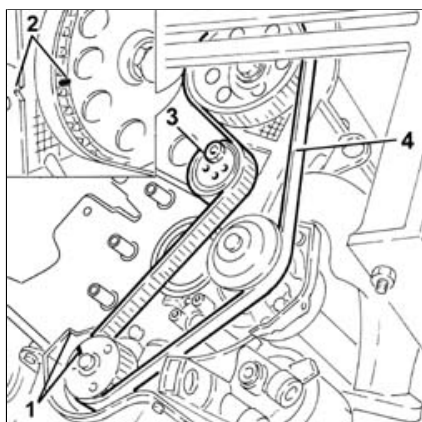

1. Rotate the toothed pulley so that the timing notches are aligned.
2. Check that the timing reference on the timing driven pulley is aligned with the reference on the cylinder head.
3. Loosen the timing belt moving tensioner nut.
4. Remove the timing drive belt.

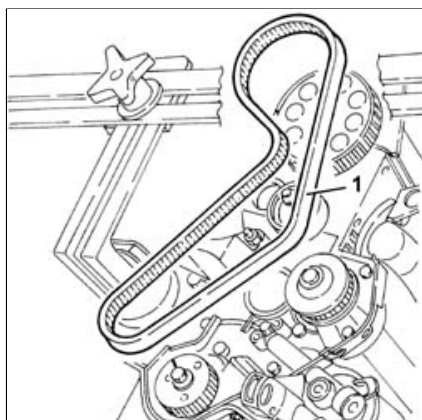

Refitting ([Removing](#))

Check that the timing references on the driven pulley and the drive pulley are still aligned during the removal.

1. Fit the timing belt.

1. Fit the tools (1a) and (1b) on the timing belt moving tensioner.

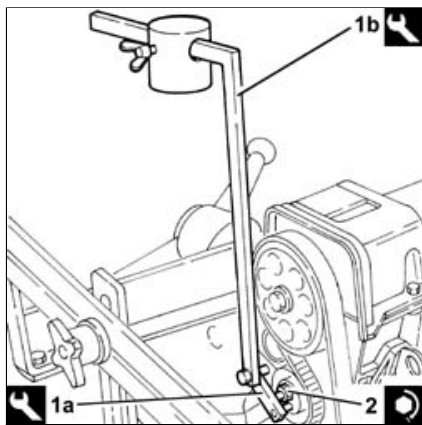

The weight for the tool (1b) should have the knurled part removed and should be positioned 65 mm away on the millimetric rod.

The millimetric rod should be placed in a horizontal position acting on the tool joint.

	Name	Country
1a	Belt tensioner	1.860.745.300
	Name	Country
1b	Belt tensioner	1.860.745.100

Let the timing belt bed in by rotating the crankshaft through two revolutions in its direction of rotation.

During this stage the millimetric rod may move away from the horizontal position; if this is the case, adjust the joint on the tool and repeat the operation.

2. Tighten the nut fixing the timing belt moving tensioner to the recommended torque.

	Fastening	Component	Ø	Value (daNm)
2	Nut	MOBILE TIMING TENSIONER	M8 x 1.25	2.8

Refit the lower shield and the upper shield for the timing drive belt.

Fit the auxiliary shaft drive pulley on the crankshaft and tighten the fixing bolts to the recommended torque.

	Fastening	Component	Ø	Value (daNm)
-	Bolt	CRANKSHAFT PULLEY	M8 x 1.25	2.2

Fit the rpm and TDC sensor and secure it using the bolt and reconnect the connection.

	Name	Connector
-	Rpm sensor	K46

Fit the engine oil dipstick.

- **1004D40 engine - position on stand and remove**