

PANDA 1.1 toothed timing belt - r + r for timing adjustment or replacement 1032B10

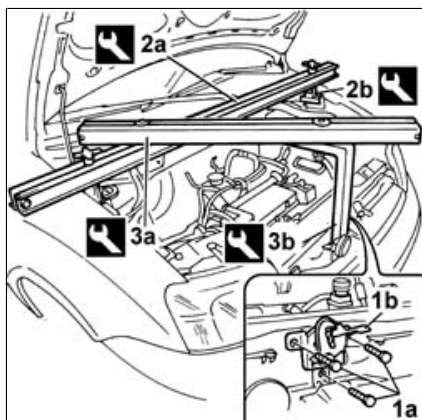

Removing ([Refitting](#))

Disconnect the battery negative terminal.

- **1048A10** air cleaner filtering element - replace
- **5510C30** engine timing sensor - r+r
- **4450B04** right front wheel r r
- **5510C26** rpm sensor - r+r
- **1092B60** alternator drive belt - r + r
- **1092A10** Crankshaft services PULLEY - R.R.
- **1032D12** timing system protective cover(s) - r + r
- **7055A42** front grille - r+r

1. Undo the fixing bolts (1a) and move aside the catch (1b) without disconnecting the control cable.

2. Fit the tool (2a), complete with support mountings (2b).

	Name	Country
☐		
2a	Crossmember	1.870.595.000
☐	Name	Country
2b	Support mountings	1.870.650.000

3. Fit the tools (3a) and (3b), then connect them to the tool fitted previously.

	Name	Country
☐		
3a	Crossmember	1.860.851.003
☐	Name	Country
3b	Vertical support	1.871.001.300

1. Position a suitable bracket (1a) and anchor it to the hook of the crossmember (1b) previously positioned to support the power unit.

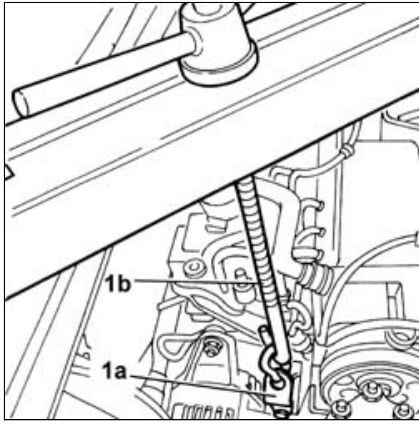

1. Unscrew nuts (1a) securing the flexible block (1b) to the timing end engine mount and remove it.

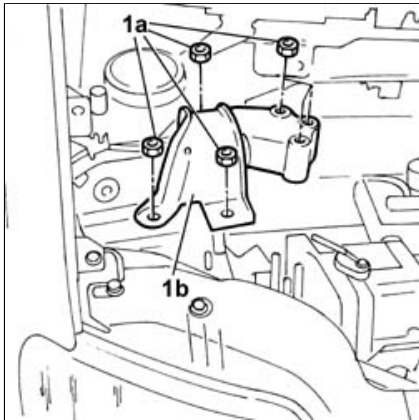

1. Undo the fixing bolts (1a) and remove the rigid engine mount (1b).

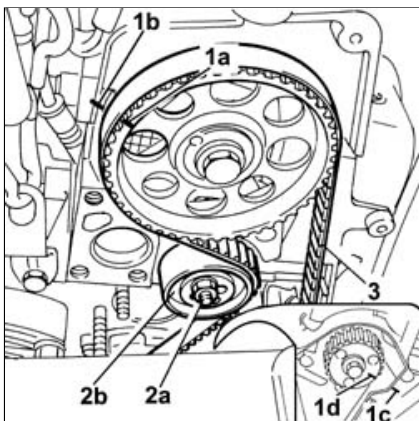
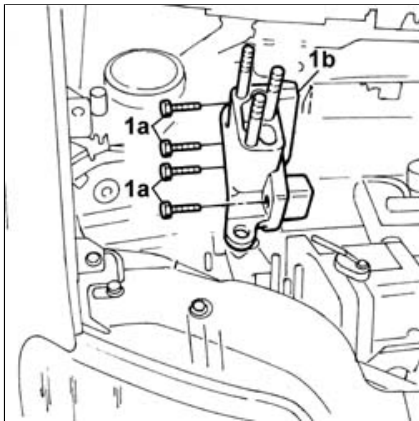

1. Turn the crankshaft until the mark on the driven pulley (1a) lines up with the mark on the cylinder head (1b) and the mark on the drive pulley (1c) lines up with the reference (1d) located on the oil pump casing.
 2. Undo the fixing nut (2a) and loosen the timing belt moving tensioner (2b).
 3. Undo and remove the toothed timing belt.

Refitting ([Removing](#))

1. Before fitting the toothed timing belt check that the references are lined up, making sure

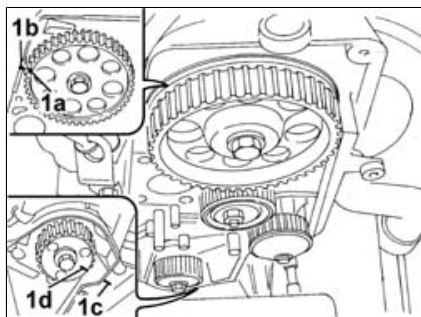

that the mark on the driven pulley (1a) lines up with the mark on the cylinder head (1b) and the mark on the drive pulley (1c) lines up with the reference (1d) located on the oil pump casing.

If the reference marks do not line up, move both the crankshaft and camshaft very small amounts until the marks line up.

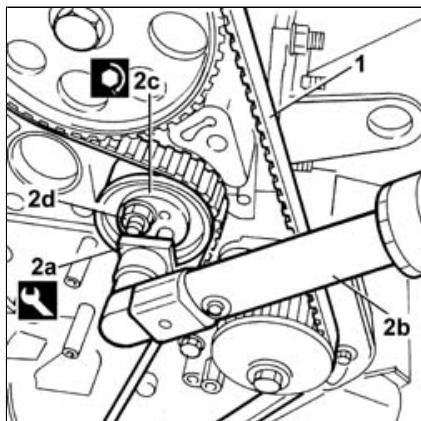

1. Fit the toothed timing belt in its seating.
2. Position the tool (2a) and using a torque wrench (2b) preload the timing belt moving tensioner (2c) and loosely tighten the fixing nut (2d).

<input type="checkbox"/>	Name		Country	
2a	Adaptor		1.871.001.400	
<input type="checkbox"/>	Fastening	Component	Ø	Value (daNm)
2c	-	MOBILE TIMING TENSIONER	-	(Preloading toothed timing belt moving tensioner) 0.7

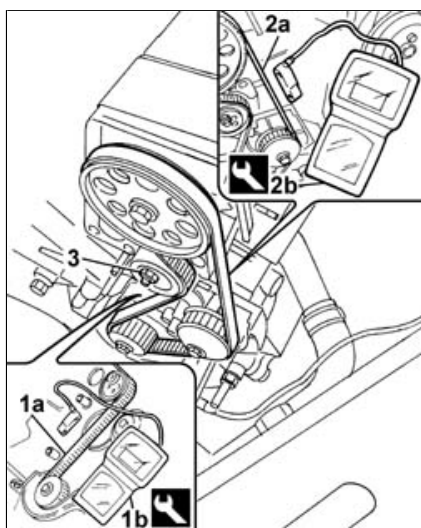

Rotate the crankshaft through two revolutions and check that the references on the driven pulley and the drive pulley coincide with the fixed references on the cylinder head and the oil pump casing, respectively.

1. Measure the tension on the slack branch (1a) of the toothed timing belt using the special tool (1b).

Keep the measuring instrument's sensor at a distance of about 1 cm from the belt.

<input type="checkbox"/>	Name		Country	
1b	Belt tension measuring instrument		1.871.001.500	

2. Measure the tension on the taut branch (2a) of the toothed timing belt using a special tool (2b).

Keep the measuring instrument's sensor at a distance of about 1 cm from the belt.

<input type="checkbox"/>	Name		Country	
1b	Belt tension measuring instrument		1.871.001.500	

Add together the values measured on the two branches of the toothed timing belt and check that the value is within the following parameters:

<input type="checkbox"/>	Measurement	Value	

-	Tension of toothed timing belt (Hz)	160 - 210
---	-------------------------------------	-----------

3. Tighten to torque the nut securing the toothed timing belt moving tensioner.

<input type="checkbox"/>	Fastening	Component	Ø	Value (daNm)
3	Nut	MOBILE TIMING TENSIONER	M8 x 1.25	2.8 +/- 10 %

Fit in its seating the power unit rigid support and tighten the bolts to the specified torque.

<input type="checkbox"/>	Fastening	Component	Ø	Value (daNm)
-	Bolt	ENGINE MOUNT TIMING SIDE	M10 x 1.25	6
<input type="checkbox"/>	Fastening	Component	Ø	Value (daNm)
-	Bolt	ENGINE MOUNT TIMING SIDE	M8 x 1.25	2.2

Fit the flexible block in its seating and tighten the nuts to the specified torque.

<input type="checkbox"/>	Fastening	Component	Ø	Value (daNm)
-	Nut	FRONT RUBBER MOUNTS	M10 x 1.25	5

Remove the power unit anchoring bracket fitted previously.

Remove the tools supporting the power unit fitted previously.

<input type="checkbox"/>	Name	Country
-	Crossmember	1.870.595.000
<input type="checkbox"/>	Name	Country
-	Support mountings	1.870.650.000
<input type="checkbox"/>	Name	Country

-	Crossmember	1.860.851.003
	Name	Country
-	Vertical support	1.871.001.300

Position the bonnet catch in its seating and tighten the fixing bolts.

- **7055A42 front grille - r+r**
- **1032D12 timing system protective cover(s) - r + r**
- **1092A10 Crankshaft services PULLEY - R.R.**
- **1092B60 alternator drive belt - r + r**
- **1092B64 alternator drive belt - adjust tension**
- **5510C26 rpm sensor - r+r**
- **4450B04 right front wheel r r**
- **5510C30 engine timing sensor - r+r**
- **1048A10 air cleaner filtering element - replace**