

### 10.

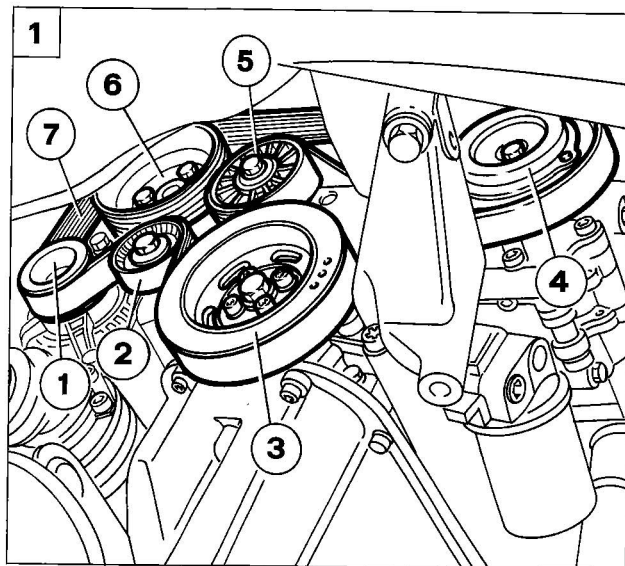

P4F10GX01



### REMOVING - REFITTING AUXILIARY COMPONENT BELT

1. View of auxiliary belt fitted to the vehicle:

1. Alternator
2. Automatic tensioner
3. Crankshaft pulley
4. Air conditioner compressor pulley
5. Fixed tensioner
6. Power steering pump pulley
7. Auxiliary component belt

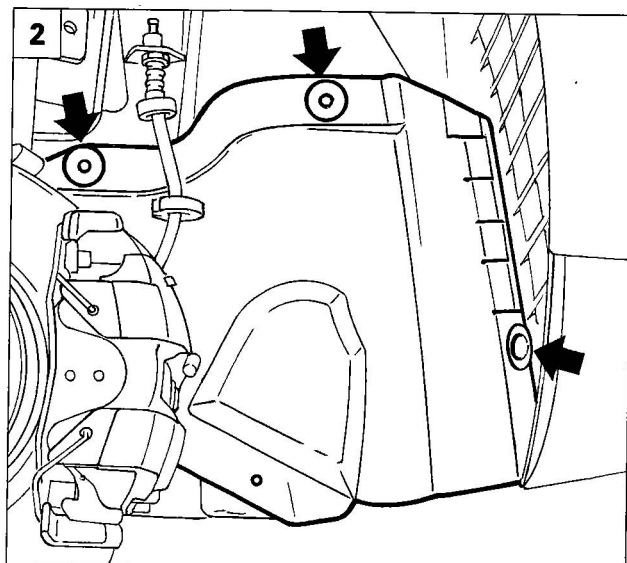

P4F12EX01



### Removing

Position the vehicle on a lift, remove the right front wheel, disconnect the battery negative terminal and proceed as follows.

2. Remove the wheel arch lining by unscrewing the retaining bolts shown and use tool 1870077000 to undo the stud shown.

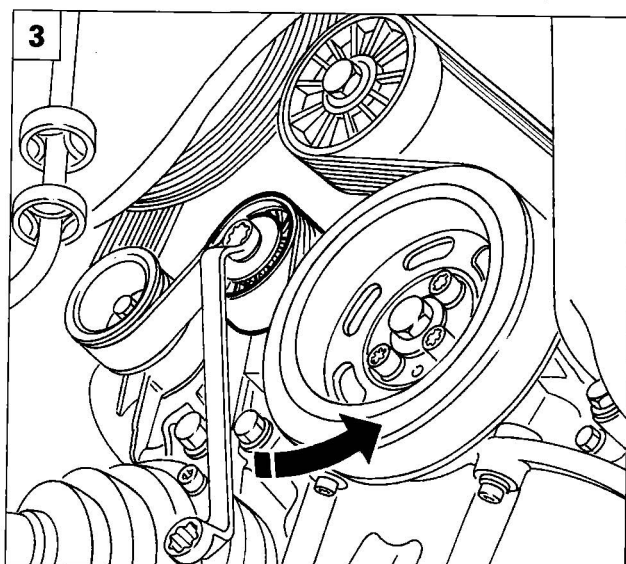

P4F10GX02



3. Turn the tensioner in the arrowed direction and release belt tension, then remove belt.



*Check belt for cracks, cuts, surface wear (smooth, shiny patches), dry or hard patches which could lead to a loss of grip. Replace the belt if any of the above defects are found.*

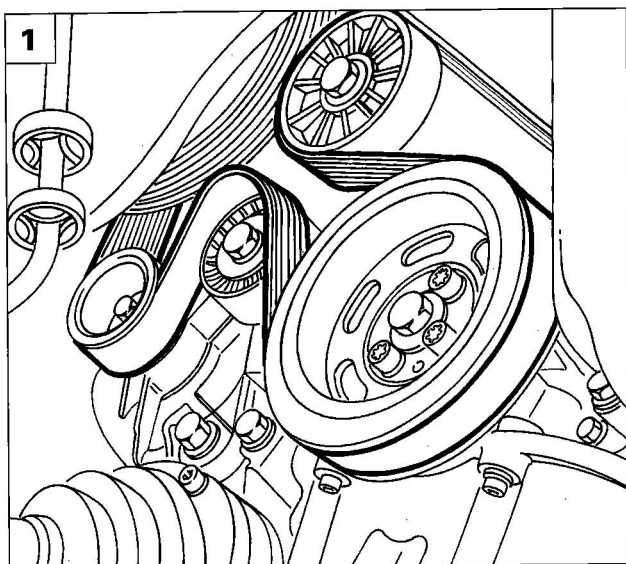

P4F11GX01

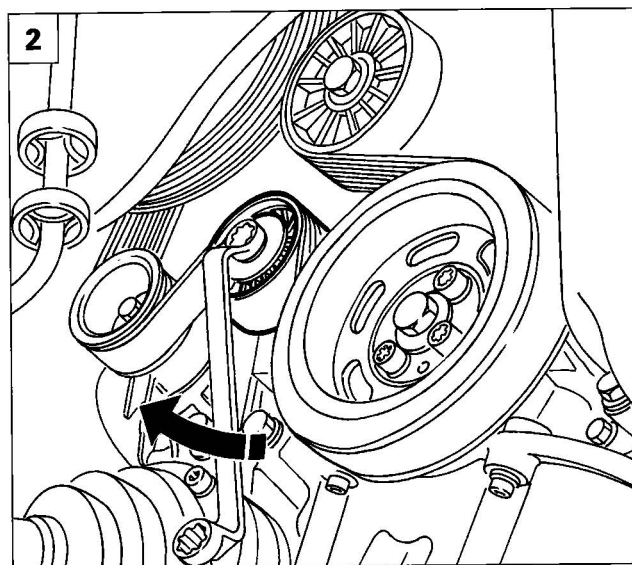

P4F11GX02

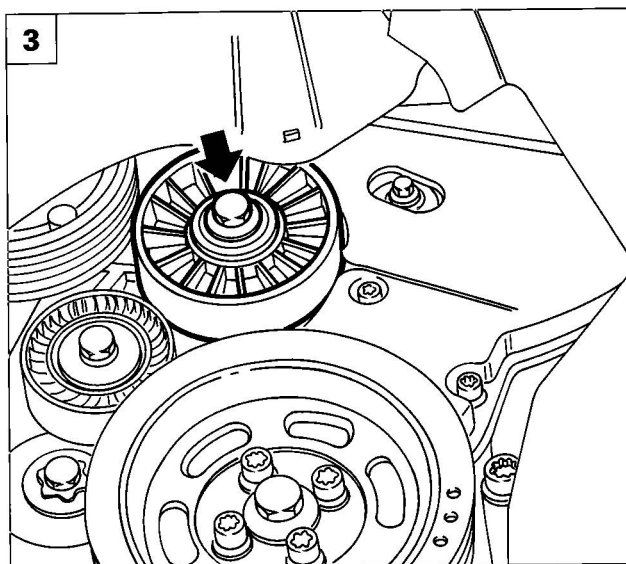

P4F11GX03

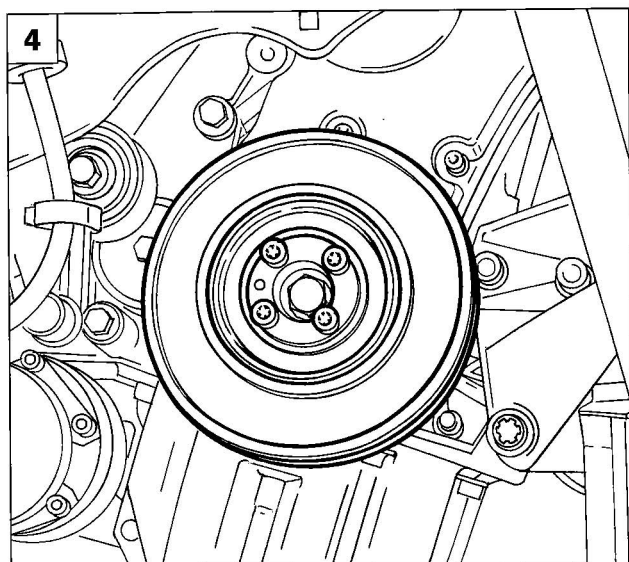

P4F14EX01

### Refitting

1. Fit a new belt as shown in the figure.



*Prevent the new belt coming into contact with oil or solvent which could affect the elasticity of the rubber and lead to a loss of grip.*

2. Return the tensioner to the position shown in the figure. The preloaded tensioner spring will ensure the belt is correctly tensioned once the crankshaft has been turned a few times.

### REPLACING TIMING BELT

#### Removing



*Before removing the timing belt, remove the auxiliary belt as described previously.*

3. Remove the lower power unit guard as described in the power unit removal procedure, then remove the auxiliary belt fixed pulley to allow removal of the timing belt guard.
4. Remove the auxiliary drive pulley from the crankshaft.