

Stilo 1.6 16v alternator - r+r 5530A10

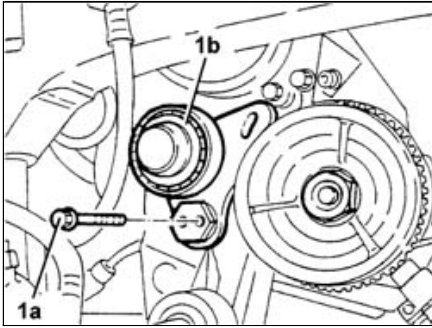

Removing ([Refitting](#))

Place the car on the ramp.

- **1016A10 sound-proofing cover - r + r**
- **5530B56 BATTERY DRIP TRAY COVER - R.R.**

Disconnect the battery negative terminal.

⚡	Name	Connector
-	Battery	A1

- **7055B54 under-engine guard - r r**
- **7055B42 Additional FRONT WHEEL ARCH (one), left or right - R.R.**
- **4450B10 Front WHEEL (one) - R.R.**
- **1092B50 alternator/air conditioner compressor drive belt - adjust tension**

1. Completely undo the bolts (1a) and remove the components drive belt moving tensioner (1b).

1. Undo and remove the alternator bottom bolt.

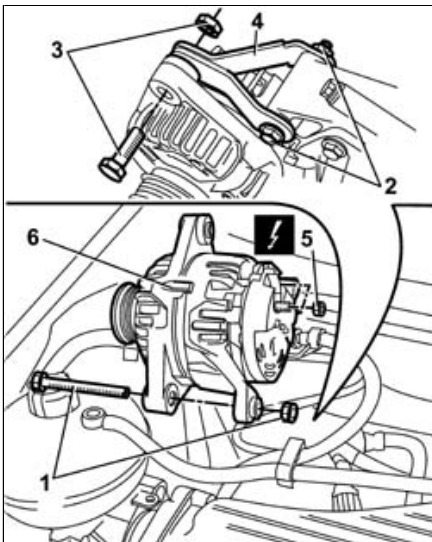

2. Slacken the bolt securing the alternator mounting bracket to the engine.

3. Undo and remove the bolt securing the alternator to the mounting bracket.

4. Rotate the alternator mounting bracket towards the engine.

5. Undo the fixing nuts and disconnect the electrical wiring.

⚡	Name	Connector
5	Alternator	A10

6. Remove the alternator

Refitting ([Removing](#))

Reconnect the alternator's electrical connections.

⚡	Name	Connector

-	Alternator	A10
---	------------	------------

Fit the alternator in its seating and secure it with the fixing bolts.

Tighten the bolts fixing the alternator to torque.

	Fastening	Component	Ø	Value (daNm)
-	Bolt	ALTERNATOR ASSEMBLY	M12	7.2 - 8.9

Place the components drive belt moving tensioner back in its housing and secure it without tightening the bolts.

- **1092B50 alternator/air conditioner compressor drive belt - adjust tension**

- **1092B54 alternator/water pump drive belt - adjust tension**

- **4450B10 Front WHEEL (one) - R.R.**

- **7055B42 Additional FRONT WHEEL ARCH (one), left or right - R.R.**

- **7055B54 under-engine guard - r r**

Connect the battery negative terminal.

	Name	Connector
-	Battery	A1

- **5530B56 BATTERY DRIP TRAY COVER - R.R.**

- **1016A10 sound-proofing cover - r + r**

Remove the car from the ramps.