

ELECTRICAL PROPERTIES

The solenoid control is variable DC (Duty Cycle) voltage type:

- maximum supply voltage (maximum DC) = maximum vacuum;
- no supply (minimum DC) - no vacuum (atmospheric pressure).

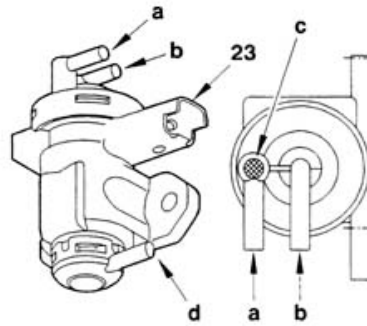

- a - user outlet;
- b - vacuum pump vacuum intake;
- c - white marking;
- d - atmospheric pressure input.